

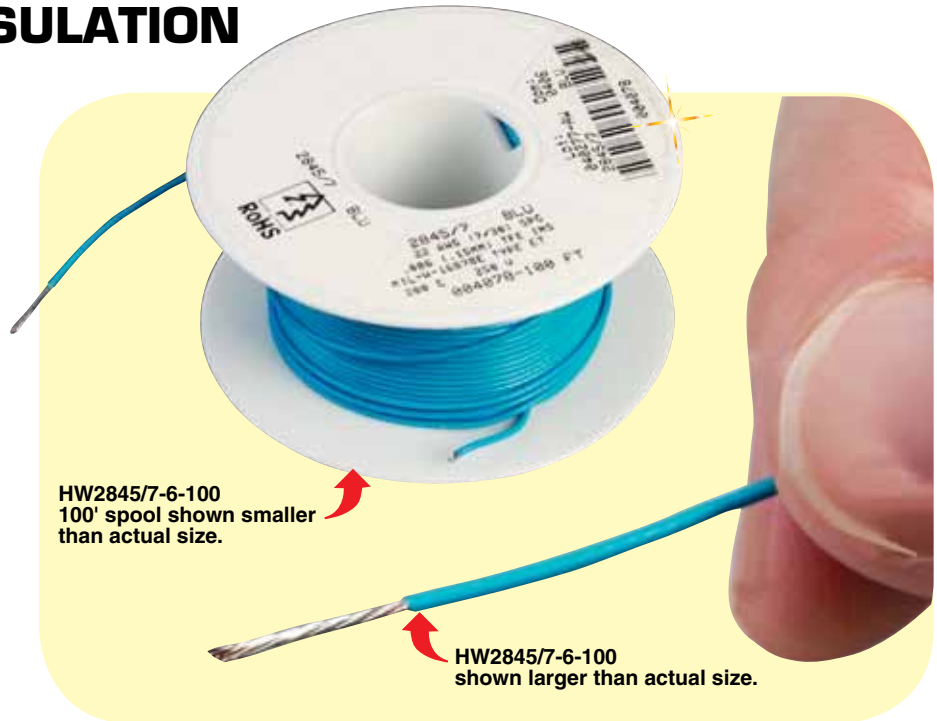

# SINGLE CONDUCTOR HOOK-UP WIRE TFE INSULATION

**HW2800 Series**



- Resistance to Most Chemicals
- Temperature Use Up to 200°C (392°F)
- -60 to 200°C (-76 to 392°F) Operating Temperature
- 250V Voltage Rating
- Stranded or Solid Silver-Plated Copper Conductor
- Color-Coded, Extruded TFE Insulation
- MIL-W-16878E Type ET

## Applications

- Military Harnessing
- Medical Electronics
- Power Supply Lead Wire
- Appliance Wiring

## COLOR CHART

1	White
2	Black
3	Red
4	Green
5	Yellow
6	Blue
7	Brown
8	Orange
9	Gray
10	Violet

## To Order

MIL-W-16878E (TYPE ET) 200°C (392°F), ROHS COMPLIANT 250V

MODEL NO.	AWG NO.	WIRE TYPE	INSULATION THICKNESS mm (inch)	NOMINAL OD mm (inch)
HW2840/7-(*)-(**)	32	7/40	0.15 (0.006)	0.53 (0.021)
HW2841/7-(*)-(**)	30	7/38	0.15 (0.006)	0.61 (0.024)
HW2842/7-(*)-(**)	28	7/36	0.15 (0.006)	0.69 (0.027)
HW2842/19-(*)-(**)	28	19/40	0.15 (0.006)	0.69 (0.027)
HW2843/7-(*)-(**)	26	7/34	0.15 (0.006)	0.79 (0.031)
HW2843/19-(*)-(**)	26	19/38	0.15 (0.006)	0.81 (0.032)
HW2844/7-(*)-(**)	24	7/32	0.15 (0.006)	0.91 (0.036)
HW2844/19-(*)-(**)	24	19/36	0.15 (0.006)	0.94 (0.037)
HW2845/7-(*)-(**)	22	7/30	0.15 (0.006)	1.07 (0.042)
HW2845/19-(*)-(**)	22	19/34	0.15 (0.006)	1.12 (0.044)
HW2841/1-(*)-(**)	30	Solid	0.15 (0.006)	0.56 (0.022)
HW2842/1-(*)-(**)	28	Solid	0.15 (0.006)	0.64 (0.025)
HW2843/1-(*)-(**)	26	Solid	0.15 (0.006)	0.71 (0.028)

\* Specify color by entering color code from the chart. \*\* Specify Length "-100" or "-1000".

Ordering Example: HW2843/7-10-100, 30 m (100') spool of 26 stranded (7 x 34), TFE insulation hook up wire, violet.